

# Vermont's Youth Need Our Support



The Vermont Department for Children and Families (DCF) has been operating without a secure facility for youth in crisis since 2020.

The **Green Mountain Youth Campus** will add capacity to the overall youth-serving system of care, increasing DCF's ability to support all youth populations needing mental health care in therapeutic settings.

## EVIDENCE-BASED DESIGN

In planning a new campus, DCF has partnered with the Department of Buildings and General Services (BGS) to create a therapeutic setting guided by the following principles:

- Physical safety and security
- A sense of belonging and connection
- Trauma-responsive, nature-centered campus
- Softer finishes and color palette to complement the natural landscape
- A nurturing environment focused on stability, growth, and life-learning

A statewide search for a site to support the unique needs of youth in crisis identified an ideal location on State-owned property in Vergennes.

Conversations with neighbors and other community members will be an integral part of project development as we move through the permitting process. **We invite you to attend the upcoming community meetings linked at the website below.**



## LOCATION

The proposed location is located west of Comfort Hill Road, just north of the solar array. Its comparatively low cost of development, proximity to support services, and beautiful natural landscape were critical factors in the selection process.

For more information, visit: <https://dcf.vermont.gov/gmyc>

# PROGRAM

The programming will focus on the inherent understanding that there is a safe place immediately available to justice-involved youth that can provide for their needs, sense of belonging, and pathway to purpose. The care offered will be rooted in evidence-based therapeutic interventions developed in collaboration with service providers and under the guidance of expert stakeholders.

## FACILITY

The proposed treatment center is a secure campus-style environment with two youth programs. Youth will be matched to the program that can best serve their individual needs:

### 8-Bed Short-Term Stabilization Program

This level of care is designed to be immediately accessible to justice involved youth at the point of life disruption. The space and services emphasize individual safety externally and internally, with a focus on preparedness for treatment.

### 6-Bed Short-Term Treatment Program

This level of care is designed to support youth with growth and personal development. The space and services emphasize community and normalcy, with a focus on integration into family and community.

## TIMELINE

The State is working to bring this project to fruition as quickly as possible, with an anticipated construction start in 2025 and a fully-operational campus in 2026.

Scan the code to learn more about the project and opportunities to provide feedback.

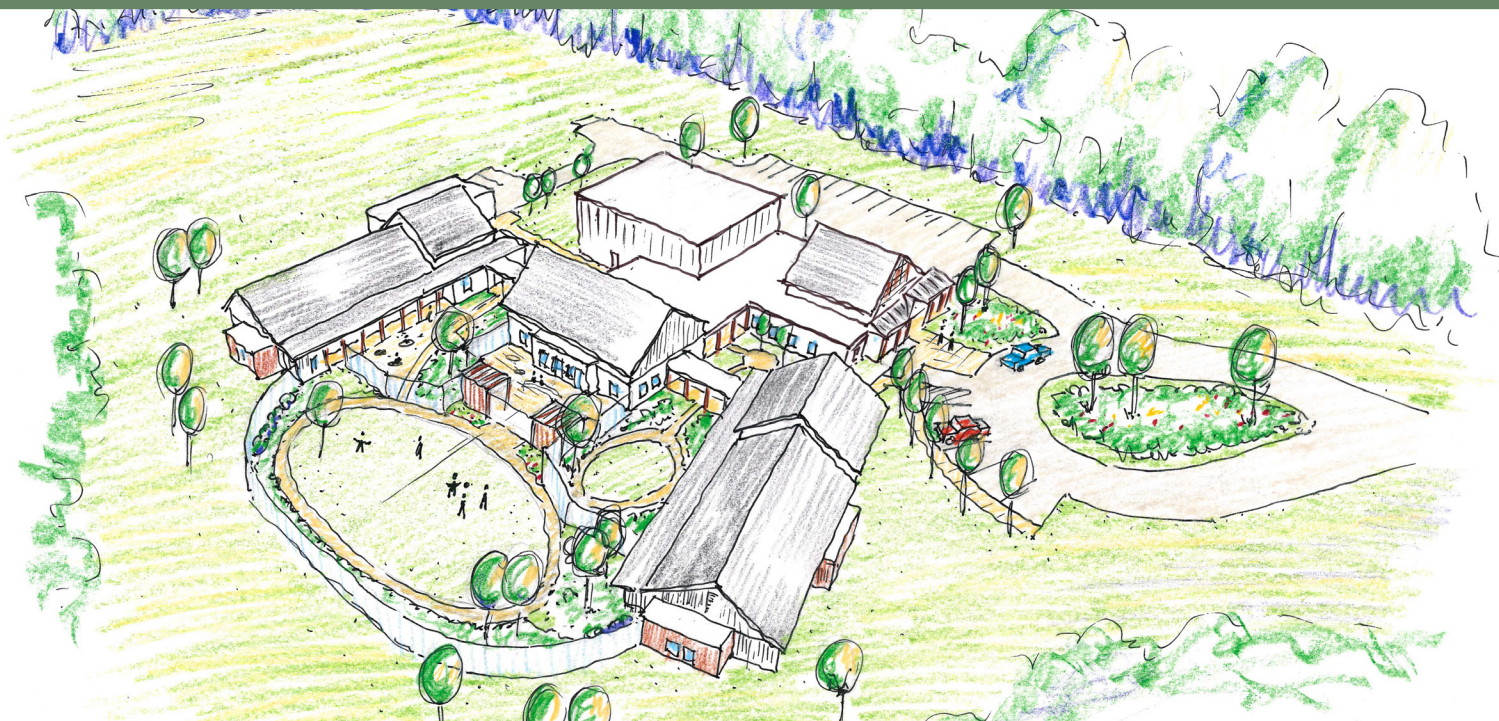

Thank you for your support.