

VC-883



VC-885



VC-886L

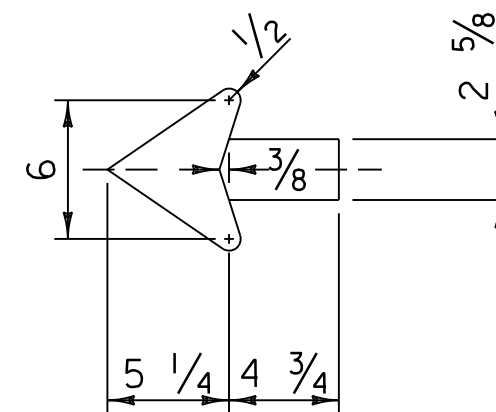

VC-886R

NOTES:

- 1. SIGNS SHALL BE 24 INCH BY 24 INCH. IF SOLID SUBSTRATE SIGNS ARE USED, SIGNS SHALL HAVE CORNERS ROUNDED TO A 1 1/2 INCH RADIUS.
- 2. SIGNS SHALL HAVE 5/8 INCH WIDE BORDERS THAT ARE INDENTED 3/8 INCH FROM THE EDGE OF THE SIGN.



VC-887

GENERAL NOTES:

- 1. COLORS FOR SIGNS SHALL BE BLACK LEGEND AND BORDER ON FLUORESCENT ORANGE BACKGROUND.
- 2. CONSTRUCTION SIGNS SHALL BE 48 INCH BY 48 INCH UNLESS OTHERWISE NOTED. IF SOLID SUBSTRATE SIGNS ARE USED, SIGNS SHALL HAVE CORNERS ROUNDED TO A THREE INCH RADIUS UNLESS OTHERWISE NOTED.
- 3. SIGNS SHALL HAVE 1 1/4 INCH WIDE BORDERS THAT ARE INDENTED 3/4 INCH FROM THE EDGE OF THE SIGN UNLESS OTHERWISE NOTED.
- 4. SIGNS SHALL HAVE THE LEGEND CENTERED HORIZONTALLY AND VERTICALLY ON THE SIGN UNLESS OTHERWISE INDICATED.
- 5. ALL DIMENSIONS SHOWN IN INCHES.

REV.	DATE	DESCRIPTION
0	AUG. 6, 2012	ORIGINAL APPROVAL
1	JUN. 24, 2025	BORDER UPDATE
OTHER STANDARDS REQUIRED: T-1		
APPROVALS ON FILE WITH VTRANS STANDARD DRAWING COMMITTEE		

CONSTRUCTION SIGN
DETAILS

